

DRAWING NUMBER:	15-142-X-XX
PRODUCT GROUP:	TERMINALS
SUB-GROUP:	MILITARY NON-INSULATED TERMINALS
DESCRIPTION:	NON-INSULATED TURRET TERMINAL

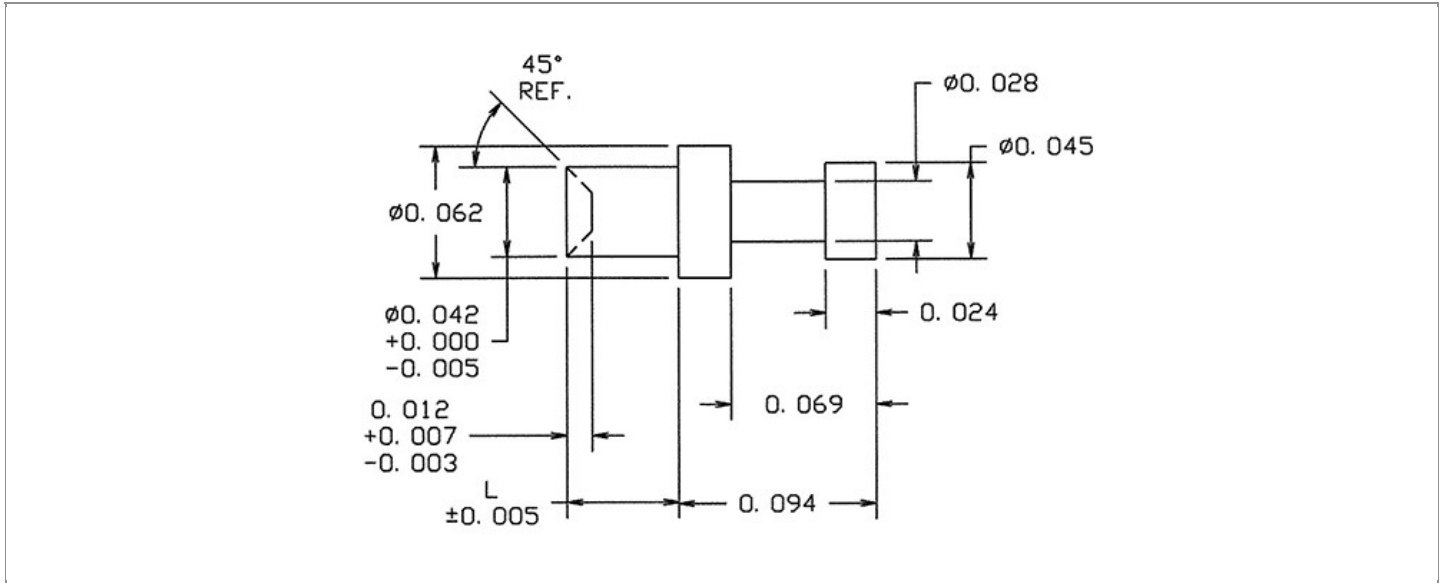

BOARD / PANEL MOUNTING METHOD	MOUNTING HOLE SIZE	DRILL SIZE	FEED THRU COMBINATION
SWAGE MOUNT	0.043" ± 0.001	#57	N/A

PART NO. STRUCTURE:

15-142 - X - XX
 PART SERIES DIMENSION FINISH

MATERIAL OPTIONS:

15-142-X-XX

COMPONENT	MATERIAL	MATERIAL AND SPECIFICATION
TERMINAL	BRASS	BRASS PER ASTM B16, ALLOY C36000, 1/2 HARD

DIMENSION OPTIONS:

15-142-X-XX

DIMENSION	K	OVERALL LENGTH	SHANK LENGTH (L)	BOARD/PANEL THICKNESS
1	N/A	0.147"	0.053"	1/32"
2	N/A	0.178"	0.084"	1/16"
11	N/A	0.131"	0.037"	1/64"

FINISH - PLATING OPTIONS:

15-142-X-XX

FINISH CODE	COMPONENT	FINISH	FINISH AND SPECIFICATION
05	TERMINAL	ELECTRO-SOLDER	0.000300"MIN. ELECTRO-SOLDER PER SAE-AMS-P-81728 OVER 0.000100"MIN. COPPER PER SAE-AMS-2418
088	TERMINAL	BRIGHT TIN-LEAD	0.000300"MIN. BRIGHT TIN-LEAD (Sn93%-Pb7%) PER ASTM B545 OVER 0.000100"MIN. COPPER PER SAE-AMS-2418
095	TERMINAL	HOT SOLDER DIP	0.000100"MIN. HOT SOLDER DIP USING Sn60 PER IPC-J-STD-006 OVER 0.000100"MIN. COPPER PER SAE-AMS-2418

TOLERANCES:*

DECIMAL	FRACTIONAL	ANGULAR	DRAWING ORIGATION DATE	LAST MODIFICATION DATE
± 0.005	N/A	± 3 °	10/22/2002	3/1/2017

*All dimensions are in inches.

RoHS COMPLIANCE:

15-142-1-XX

PART NUMBER	RoHS COMPLIANT
15-142-1-05	NO
15-142-1-088	NO
15-142-1-095	NO

15-142-2-XX

PART NUMBER	RoHS COMPLIANT
15-142-2-05	NO
15-142-2-088	NO
15-142-2-095	NO

15-142-11-XX

PART NUMBER	RoHS COMPLIANT
15-142-11-05	NO
15-142-11-088	NO
15-142-11-095	NO

MILITARY REFERENCE SPECIFICATIONS:

15-142-1-XX

PART NUMBER	MIL SPECIFICATION	MIL PART NUMBER	COMMERCIAL ITEM DESCRIPTION (CID) SPECIFICATION	CID PART NUMBER
15-142-1-05	MIL-T-55155/11	M55155/11XH09 (M55155/11-9S; SE11XC09S)	A-A-59126/11	AA59126/11XH09
15-142-1-088	MIL-T-55155/11	M55155/11XJ09	A-A-59126/11	AA59126/11XJ09 (AA59126/1109)
15-142-1-095	MIL-T-55155/11	M55155/11XI09	A-A-59126/11	AA59126/11XI09

15-142-2-XX

PART NUMBER	MIL SPECIFICATION	MIL PART NUMBER	COMMERCIAL ITEM DESCRIPTION (CID) SPECIFICATION	CID PART NUMBER
15-142-2-05	MIL-T-55155/11	M55155/11XH10 (M55155/11-10S; SE11XC10S)	A-A-59126/11	AA59126/11XH10
15-142-2-088	MIL-T-55155/11	M55155/11XJ10	A-A-59126/11	AA59126/11XJ10 (AA59126/1110)
15-142-2-095	MIL-T-55155/11	M55155/11XI10	A-A-59126/11	AA59126/11XI10

Continued on next page...

MILITARY REFERENCE SPECIFICATIONS CONTINUED:

15-142-11-XX

PART NUMBER	MIL SPECIFICATION	MIL PART NUMBER	COMMERCIAL ITEM DESCRIPTION (CID) SPECIFICATION	CID PART NUMBER
15-142-11-05	MIL-T-55155/11	M55155/11XH08 (M55155/11-8S; SE11XC08S)	A-A-59126/11	AA59126/11XH08
15-142-11-088	MIL-T-55155/11	M55155/11XJ08	A-A-59126/11	AA59126/11XJ08 (AA59126/1108)
15-142-11-095	MIL-T-55155/11	M55155/11XI08	A-A-59126/11	AA59126/11XI08

TOOLING:

INSTALLATION TOOL: ARBOR PRESS	INSTALLATION TOOL: ANVIL (ARBOR PRESS OPERATED)	INSTALLATION TOOL: PRESS-FIT / ROLL SWAGE / RIVET PUNCH (ARBOR PRESS OPERATED)	INSTALLATION TOOL: FLARE SWAGE PUNCH (ARBOR PRESS OPERATED)
TM1	TA62-45-25	TP10-142	N/A

NOTES:

DATASHEET NOTES

N/A

INSTRUCTION NOTES

SEE GENERAL SWAGING INSTALLATION INSTRUCTION ON CONCORD ELECTRONICS' WEBSITE WWW.CONCORD-ELECTRONICS.COM